

Features

- CleanCoat™ glass coating
- Stainless steel hardware prevents rusting or corrosion
- Swing-out doors for easy cleaning
- Corrosion resistant
- Watertight design
- Curved glass doors slide to left and right
- Tempered glass ensures maximum safety and durability

ROUND SHOWER ENCLOSURE K-705250

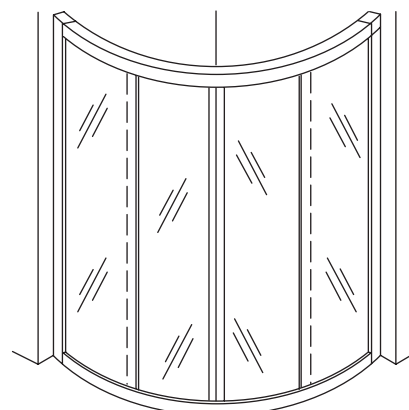

Codes/Standards Applicable

Specified model meets or exceeds the following:

- ANSI Z97.1 (tempered glass)

Glass Options

- L: Clear

Frame and Accessory Finishes/Colors:

- SH: Bright Silver
- BH: Bright Brass
- MX: Matte Nickel
- O: White
- Other: Refer to Price Book for additional colors/finishes

Specified Model

Model	Application	Glass Options	Frame Finishes/Colors			
K-705250	Round shower enclosure	<input type="checkbox"/> L	<input type="checkbox"/> SH	<input type="checkbox"/> BH	<input type="checkbox"/> MX	<input type="checkbox"/> O
Recommended Accessory						
K-9569	Shower receptor		<input type="checkbox"/> O	<input type="checkbox"/> Other_____		

Product Specification

Round shower enclosure shall have swing-out doors for easy cleaning and CleanCoat glass coating. Shower enclosure shall be corrosion resistant. Shower enclosure shall include stainless steel hardware to prevent rusting or corrosion. Shower enclosure shall have watertight design. Shower enclosure shall have left and right sliding curved tempered glass doors to ensure maximum safety and durability. Shower enclosure shall be Kohler Model K-705250-_____-_____.

Installation Notes

Install this product according to the installation guide.

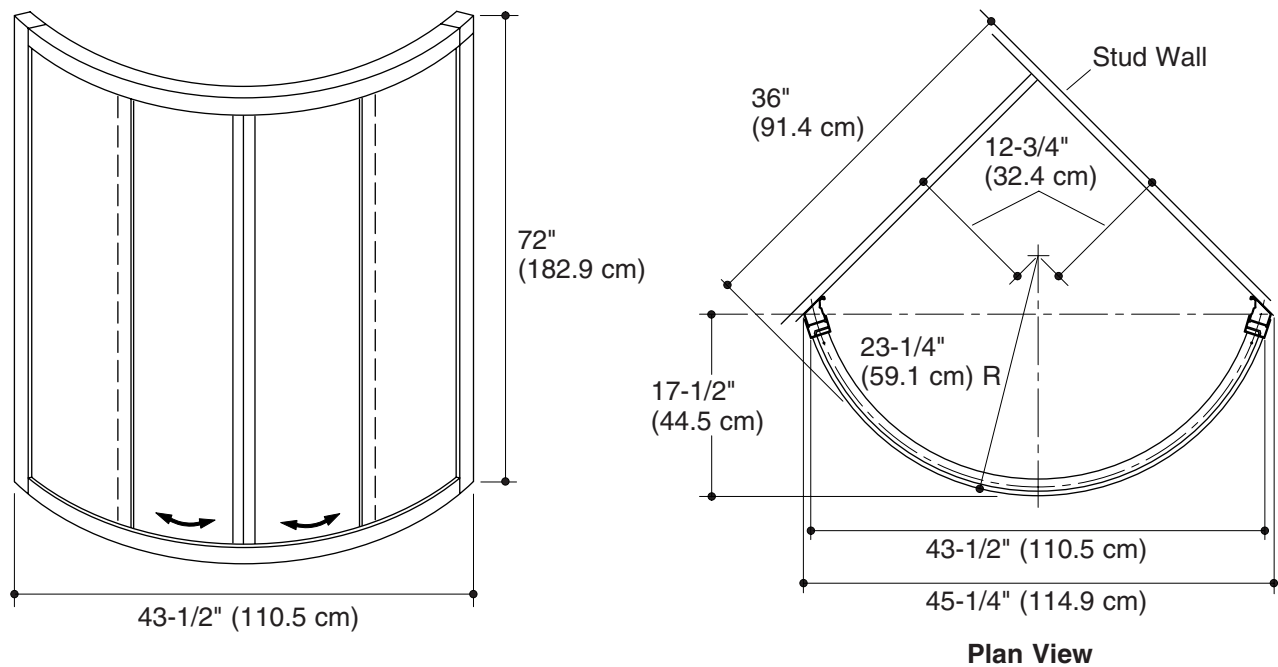

Product Diagram